



10' x 10' x 7' Manhole

Advance Concrete Products Company



(800) 824-8351 (248) 887-4173 Fax: (248) 887-2755

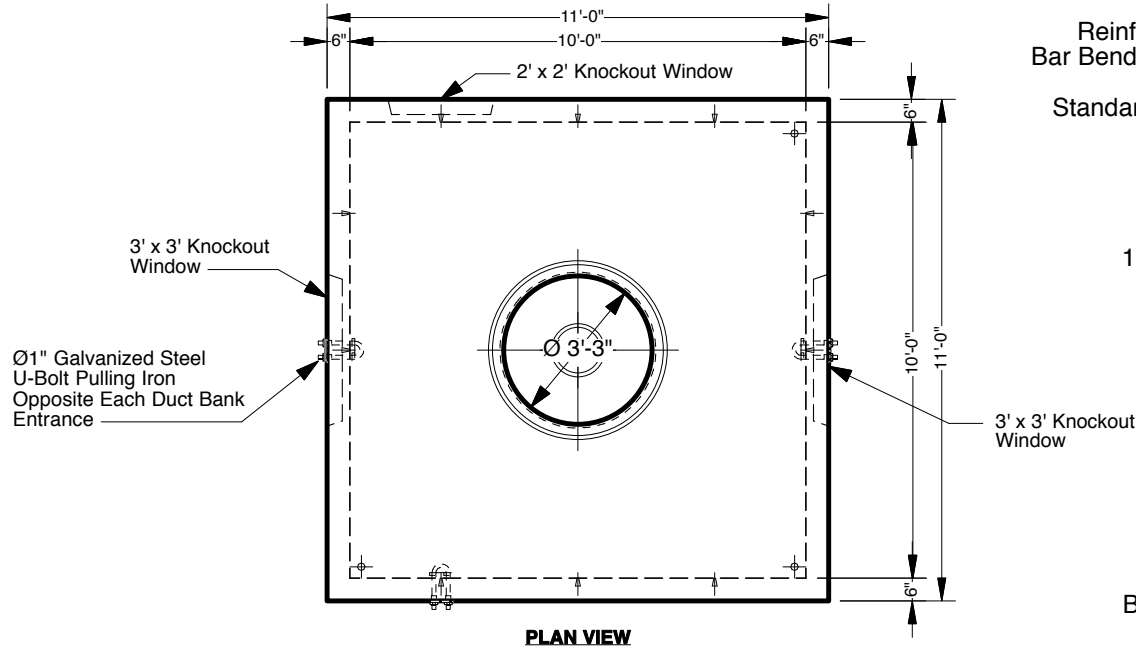

All Concrete Shall Have A 28 Day Compressive Strength Of 5000 PSI.

Reinforcing Steel Shall Comply With ASTM A615 Grade 60 Rebar. Bar Bending And Placement Shall Comply With The Latest ACI Standards.

Standard Structural Design Based On AASHTO HS 20 Wheel Loading.

Galvanized Steel Hardware
or
Non-Metallic Hardware Available.

1" Ø Butyl Rubber Rope Mastic Is Provided For Placement Between Top And Bottom Sections Of Vault.

6", 12", & 24" High Grade Adjustment Rings Are Available.

Cast Iron Frames and Covers Are Available.

Terminators Can Be Cast-in Walls for Your Conduiti.

Approximate Weight Total: ± 42,800 Lbs.
Bottom Section : ± 21,800 Lbs. Top Section: ± 21,000 Lbs.

